



OPERATOR'S MANUAL

Metal Working



TUBE AND PIPE NOTCHER MODEL: TN-300 (B8520)



REPRODUCTION OF THIS MANUAL IN ANY FORM WITHOUT WRITTEN APPROVAL OF BAILEIGH INDUSTRIAL HOLDINGS LLC IS PROHIBITED. Baileigh Industrial Holdings LLC, Inc. does not assume and hereby disclaims any liability for any damage or loss caused by an omission or error in this Operator's Manual, resulting from accident, negligence, or other occurrence.



Table of Contents

INTRODUCTION.....	1
GENERAL NOTES.....	1
SAFETY INSTRUCTIONS	2
SAFETY PRECAUTIONS	4
TECHNICAL SPECIFICATIONS	6
UNPACKING AND CHECKING CONTENTS.....	7
TRANSPORTING AND LIFTING	8
INSTALLATION.....	9
Anchoring the Machine.....	9
ELECTRICAL.....	10
OPERATION.....	12
Arbor Adapters	13
MACHINE ADJUSTMENTS	14
LUBRICATION AND MAINTENANCE	14
PARTS DIAGRAM	15
Handwheel Assembly Parts Diagram	15
Main Tube Assembly Parts Diagram	16
Roller Base Assembly Parts Diagram.....	17
Lock Nut Assembly Parts Diagram.....	18
Vise Assembly Parts Diagram	19
Electrical Box Assembly Parts Diagram	20
Parts List	21
ELECTRICAL SCHEMATIC.....	24



INTRODUCTION

The quality and reliability of the components assembled on a Baileigh Industrial Holdings LLC machine guarantee near perfect functioning, free from problems, even under the most demanding working conditions. However, if a situation arises, refer to the manual first. If a solution cannot be found, contact the distributor where you purchased our product. Make sure you have the serial number and production year of the machine (stamped on the nameplate). For replacement parts refer to the assembly numbers on the parts list drawings.

In this manual you will find: (when applicable)

- Safety procedures
- Correct installation guidelines
- Description of the functional parts of the machine
- Capacity charts
- Setup and start-up instructions
- Machine operation
- Scheduled maintenance
- Parts lists

GENERAL NOTES

After receiving your equipment remove the protective container. Do a complete visual inspection, and if damage is noted, **photograph it for insurance claims** and contact your carrier at once, requesting inspection. Also contact your retailer and inform them of the unexpected occurrence. Temporarily suspend installation.

Take necessary precautions while loading / unloading or moving the machine to avoid any injuries.

Your machine is designed and manufactured to work smoothly and efficiently. Following proper maintenance instructions will help ensure this. Try and use original spare parts, whenever possible, and most importantly; **DO NOT** overload the machine or make any modifications.



Note: This symbol refers to useful information throughout the manual.



IMPORTANT

PLEASE READ THIS OPERATORS MANUAL CAREFULLY

It contains important safety information, instructions, and necessary operating procedures. The continual observance of these procedures will help increase your production and extend the life of the equipment.

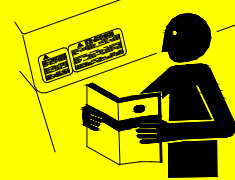

SAFETY INSTRUCTIONS

LEARN TO RECOGNIZE SAFETY INFORMATION

This is the safety alert symbol. When you see this symbol on your machine or in this manual, **BE ALERT TO THE POTENTIAL FOR PERSONAL INJURY!**



Follow recommended precautions and safe operating practices.

UNDERSTAND SIGNAL WORDS

A signal word – **DANGER**, **WARNING**, or **CAUTION** – is used with the safety alert symbol. **NOTICE**, which is not related to personal injury, is used without a symbol.

DANGER: Indicates a hazardous situation which, if not avoided, will result in death or serious injury.

WARNING: Indicates a hazardous situation which, if not avoided, could result in death or serious injury.

CAUTION: Indicates a hazardous situation which, if not avoided, could result in minor or moderate injury.

NOTICE: Indicates a situation which, if not avoided, could result in property damage.

DANGER

WARNING

CAUTION

NOTICE



SAVE THESE INSTRUCTIONS.
Refer to them often and use them to instruct others.



PROTECT EYES

Wear safety glasses or suitable eye protection when working on or around machinery.

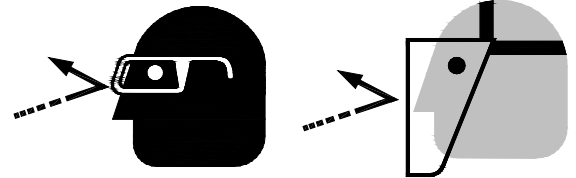

PROTECT AGAINST NOISE

Prolonged exposure to loud noise can cause impairment or loss of hearing. Wear suitable hearing protective devices such as ear muffs or earplugs to protect against objectionable or uncomfortable loud noises.

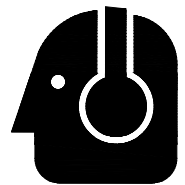

BEWARE OF PIERCING POINTS

NEVER place hands, fingers, or any part of your body near rotating tools. Hole saws are very sharp and can quickly pierce your fingers and hands. Always wear heavy leather gloves when handling these tools.

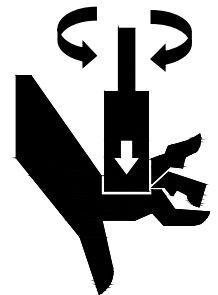

ENTANGLEMENT HAZARD – ROTATING SPINDLE

Contain long hair, **DO NOT** wear jewelry or loose fitting clothing.

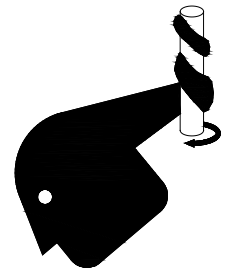



SAFETY PRECAUTIONS



Metal working can be dangerous if safe and proper operating procedures are not followed. As with all machinery, there are certain hazards involved with the operation of the product. Using the machine with respect and caution will considerably lessen the possibility of personal injury. However, if normal safety precautions are overlooked or ignored, personal injury to the operator may result.

Safety equipment such as guards, hold-downs, safety glasses, dust masks and hearing protection can reduce your potential for injury. But even the best guard will not make up for poor judgment, carelessness or inattention. **Always use common sense** and exercise **caution** in the workshop. If a procedure feels dangerous, don't try it.

REMEMBER: Your personal safety is your responsibility.



WARNING: FAILURE TO FOLLOW THESE RULES MAY RESULT IN SERIOUS PERSONAL INJURY

Dear Valued Customer:

- All Baileigh machines should be used only for their intended use.
- Baileigh does not recommend or endorse making any modifications or alterations to a Baileigh machine. Modifications or alterations to a machine may pose a substantial risk of injury to the operator or others and may do substantial damage to the machine.
- Any modifications or alterations to a Baileigh machine will invalidate the machine's warranty.

PLEASE ENJOY YOUR BAILEIGH MACHINE!PLEASE ENJOY IT SAFELY!

1. **FOR YOUR OWN SAFETY, READ INSTRUCTION MANUAL BEFORE OPERATING THE MACHINE.** Learn the machine's application and limitations as well as the specific hazards.
2. **Only trained and qualified personnel can operate this machine.**
3. **Make sure guards are in place and in proper working order before operating machinery.**
4. **Remove any adjusting tools.** Before operating the machine, make sure any adjusting tools have been removed.
5. **Keep work area clean.** Cluttered areas invite injuries.
6. **Overloading machine.** By overloading the machine, you may cause injury from flying parts. **DO NOT** exceed the specified machine capacities.
7. **Dressing material edges.** Always chamfer and deburr all sharp edges.



8. **Do not force tool.** Your machine will do a better and safer job if used as intended. **DO NOT** use inappropriate attachments in an attempt to exceed the machines rated capacity.
9. **Use the right tool for the job. DO NOT** attempt to force a small tool or attachment to do the work of a large industrial tool. **DO NOT** use a tool for a purpose for which it was not intended.
10. **Dress appropriate. DO NOT** wear loose fitting clothing or jewelry as they can be caught in moving machine parts. Protective clothing and steel toe shoes are recommended when using machinery. Wear a restrictive hair covering to contain long hair.
11. **Use eye and ear protection.** Always wear ISO approved impact safety goggles. Wear a full-face shield if you are producing metal filings.
12. **Do not overreach.** Maintain proper footing and balance at all times. **DO NOT** reach over or across a running machine.
13. **Stay alert.** Watch what you are doing and use common sense. **DO NOT** operate any tool or machine when you are tired.
14. **Check for damaged parts.** Before using any tool or machine, carefully check any part that appears damaged. Check for alignment and binding of moving parts that may affect proper machine operation.
15. **Observe work area conditions. DO NOT** use machines or power tools in damp or wet locations. Do not expose to rain. Keep work area well lighted. **DO NOT** use electrically powered tools in the presence of flammable gases or liquids.
16. **Blade adjustments and maintenance.** Always keep blades sharp and properly adjusted for optimum performance.
17. **Keep children away.** Children must never be allowed in the work area. **DO NOT** let them handle machines, tools, or extension cords.
18. **Store idle equipment.** When not in use, tools must be stored in a dry location to inhibit rust. Always lock up tools and keep them out of reach of children.
19. **DO NOT operate machine if under the influence of alcohol or drugs.** Read warning labels on prescriptions. If there is any doubt, **DO NOT** operate the machine.
20. **DO NOT** touch live electrical components or parts.
21. **Turn off** power before checking, cleaning, or replacing any parts.
22. Be sure **all** equipment is properly installed and grounded according to national, state, and local codes.
23. Inspect power and control cables periodically. Replace if damaged or bare wires are exposed. **Bare wiring can kill!**
24. **DO NOT** bypass or defeat any safety interlock systems.
25. Keep visitors a safe distance from the work area.



TECHNICAL SPECIFICATIONS

Notching Capacity (OD)	15.8 – 76.2mm
Angle Adjustment	0 – 220°
Spindle Speed	200rpm
Power	240V / 50hz
Motor	1/2HP (.4kw) / 9A
Shipping Weight	120kg
Shipping Dimensions	1220 x 788 x 788mm



Note: *The photos and illustrations used in this manual are representative only and may not depict the actual color, labeling or accessories and may be intended to illustrate technique only.*



Note: *The specifications and dimensions presented here are subject to change without prior notice due to improvements of our products.*



UNPACKING AND CHECKING CONTENTS

Your Baileigh machine is shipped complete. Separate all parts from the packing material and check each item carefully. Make certain all items are accounted for before discarding any packing material.

⚠ WARNING: SUFFOCATION HAZARD! Immediately discard any plastic bags and packing materials to eliminate choking and suffocation hazards to children and animals.
If any parts are missing, **DO NOT** place the machine into service until the missing parts are obtained and installed correctly.

Cleaning

⚠ WARNING: DO NOT USE gasoline or other petroleum products to clean the machine. They have low flash points and can explode or cause fire.

⚠ CAUTION: When using cleaning solvents work in a well-ventilated area. Many cleaning solvents are toxic if inhaled.

Your machine may be shipped with a rustproof waxy coating and/or grease on the exposed unpainted metal surfaces. Fully and completely remove this protective coating using a degreaser or solvent cleaner. Moving items will need to be moved along their travel path to allow for cleaning the entire surface. For a more thorough cleaning, some parts will occasionally have to be removed. **DO NOT USE** acetone or brake cleaner as they may damage painted surfaces.

Follow manufacturer's label instructions when using any type of cleaning product. After cleaning, wipe unpainted metal surfaces with a light coating of quality oil or grease for protection.



Important: This waxy coating is **NOT** a lubricant and will cause the machine to stick and lose performance as the coating continues to dry.





TRANSPORTING AND LIFTING

NOTICE: *Lifting and carrying operations should be carried out by skilled workers, such as a truck operator, crane operator, etc. If a crane is used to lift the machine, attach the lifting chain carefully, making sure the machine is well balanced.*

Follow these guidelines when lifting with truck or trolley:

- The lift truck must be able to lift at least 1.5 – 2 times the machines gross weight.
- Make sure the machine is balanced. While transporting, avoid rough or jerky motion, and maintain a safe clearance zone around the transport area.
- Use a forklift with sufficient lifting capacity and forks that are long enough to reach the complete width of the machine.
- Remove the securing bolts that attach the machine to the pallet.
- Approaching the machine from the side, lift the machine on the frame taking care that there are no cables or pipes in the area of the forks.
- Move the machine to the required position and lower gently to the floor.
- Level the machine so that all the supporting feet are taking the weight of the machine and no rocking is taking place.

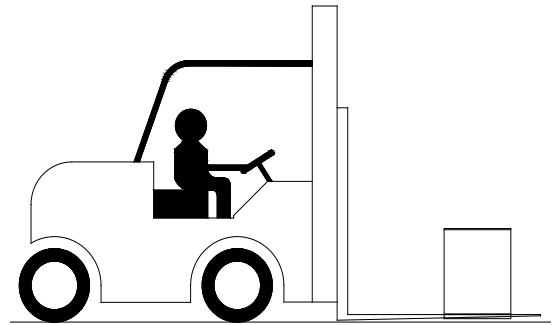

Follow these guidelines when lifting crane or hoist:

- Always lift and carry the machine with the lifting holes provided at the top of the machine.
- Use lift equipment such as straps, chains, capable of lifting 1.5 to 2 times the weight of the machine.
- Take proper precautions for handling and lifting.
- Check if the load is properly balanced by lifting it an inch or two.
- Lift the machine, avoiding sudden accelerations or quick changes of direction.
- Locate the machine where it is to be installed, then lower slowly until it touches the floor.



INSTALLATION

IMPORTANT:

Consider the following when looking for a suitable location to place the machine:

- Overall weight of the machine.
- Weight of material being processed.
- Sizes of material to be processed through the machine.
- Space needed for auxiliary stands, worktables, or other machinery.
- Clearance from walls and other obstacles.
- Maintain an adequate working area around the machine for safety.
- Have the work area well illuminated with proper lighting.
- Keep the floor free of oil and make sure it is not slippery.
- Remove scrap and waste materials regularly, and make sure the work area is free from obstructing objects.
- If long lengths of material are to be fed into the machine, make sure that they will not extend into any aisles.
- **LEVELING:** The machine should be sited on a level, concrete floor. Provisions for securing it should be in position prior to placing the machine. The accuracy of any machine depends on the precise placement of it to the mounting surface.
- **FLOOR:** This machine distributes a large amount of weight over a small area. Make certain that the floor is capable of supporting the weight of the machine, work stock, and the operator. The floor should also be a level surface. If the unit wobbles or rocks once in place, be sure to eliminate by using shims.
- **WORKING CLEARANCES:** Take into consideration the size of the material to be processed. Make sure that you allow enough space for you to operate the machine freely.
- **POWER SUPPLY PLACEMENT:** The power supply should be located close enough to the machine so that the power cord is not in an area where it would cause a tripping hazard. Be sure to observe all electrical codes if installing new circuits and/or outlets.

Anchoring the Machine

This machine is generally mounted on a bench top. If you intend to mount this machine on a workbench be aware of the following:

- Make sure the workbench is properly reinforced to support the weight.
- The strongest mounting option is where the holes are drilled all the way through the workbench and the machine is secured with bolts, washers, and nuts.



ELECTRICAL

 **CAUTION:** HAVE ELECTRICAL UTILITIES CONNECTED TO MACHINE BY A CERTIFIED ELECTRICIAN!
Check if the available power supply is the same as listed on the machine nameplate.

 **WARNING:** Make sure the grounding wire (green) is properly connected to avoid electric shock. DO NOT switch the position of the green grounding wire if any electrical plug wires are switched during hookup.

Power Specifications

Your machine is wired for 240 volts, 50hz alternating current. Before connecting the machine to the power source, make sure the power source is OFF.

Before switching on the power, you must check the voltage and frequency of the power to see if they meet with the requirement, the allowed range for the voltage is $\pm 5\%$, and for the frequency is $\pm 1\%$.

Considerations

- Observe local electrical codes when connecting the machine.
- The circuit should be protected with a time delay fuse or circuit breaker with an amperage rating slightly higher than the full load current of machine.
- A separate electrical circuit should be used for your machines. Before connecting the motor to the power line, make sure the switch is in the "OFF" position and be sure that the electric current is of the same characteristics as indicated on the machine.
- All line connections should make good contact. Running on low voltage will damage the motor.
- In the event of a malfunction or breakdown, grounding provides a path of least resistance for electric current to reduce the risk of electric shock. This machine is equipped with an electric cord having an equipment-grounding conductor and a grounding plug. The plug must be plugged into a matching outlet that is properly installed and grounded in accordance with all local codes and ordinances.

 **WARNING:** In all cases, make certain the receptacle in question is properly grounded. If you are not sure, have a qualified electrician check the receptacle.



- Improper connection of the equipment-grounding conductor can result in risk of electric shock. The conductor with insulation having an outer surface that is green with or without yellow stripes is the equipment-grounding conductor. If repair or replacement of the electric cord or plug is necessary, do not connect the equipment-grounding conductor to a live terminal.
- Check with qualified electrician or service personnel if the grounding instructions are not completely understood, or if in doubt as to whether the machine is properly grounded.
- Repair or replace damaged or worn cord immediately.

Extension Cord Safety

Extension cord should be in good condition and meet the minimum wire gauge requirements listed below:

AMP RATING	LENGTH		
	25ft	50ft	100ft
1-12	16	16	14
13-16	14	12	12
17-20	12	12	10
21-30	10	10	No
WIRE GAUGE			

An undersized cord decreases line voltage, causing loss of power and overheating. All cords should use a ground wire and plug pin. Replace any damaged cords immediately.



OPERATION

⚠ CAUTION: Always wear proper eye protection with side shields, safety footwear, and leather gloves to protect from burrs and sharp edges. When handling large heavy materials make sure they are properly supported.

This notcher uses replaceable hole-saws to produce quality notches in various materials at almost unlimited angles.

1. Before notching can take place, the correct hole-saw must be selected to match the material being notched.



Note: Only heavy duty hole saws can be used. The hole-saws with solid backing plates are best. The stamped and formed hole-saws are not rigid enough for this machine. The hole-saws simply screw onto the arbor.

2. Loosen the vise lock lever and rotate to the desired notch angle and re-tighten.

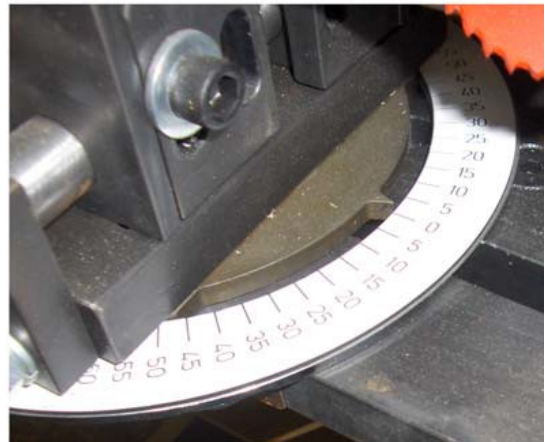
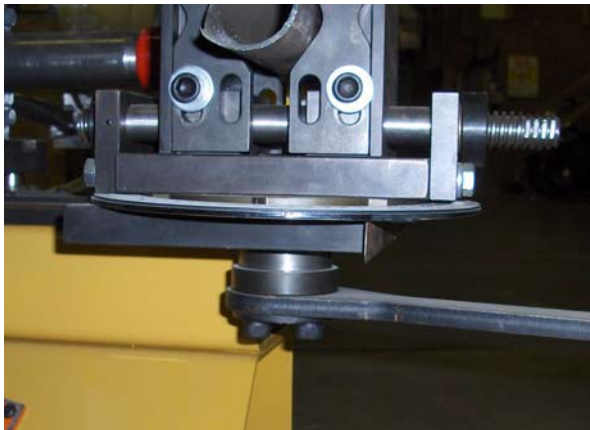

3. Select the material and insert it into the vise. Leave the minimum required material hanging beyond the vise.

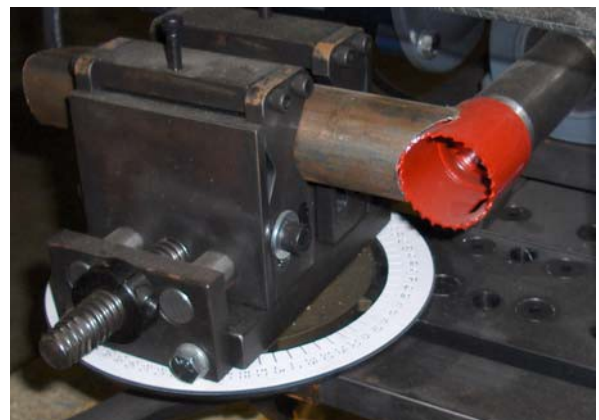



4. Start the notcher with the on/off switch.
5. Grasp the feed hand wheel and SLOWLY feed the hole-saw into the tubing. Continue feeding completely through the material to complete the notch.
6. The speed of the hole-saw is fixed and is correct for most sizes.
7. If you encounter chatter, feed slower and make sure the "V" rollers have enough tension on them. The feed hand wheel should have a slight resistance set by the "V" rollers; if the rollers should loosen up, they will need to be adjusted to give them some resistance.



Arbor Adapters

When setting up the notcher, use the correct arbor to saw adapter to fit the size and manufacturer of the hole saw being used.

		Hole Saw End
		Arbor End
Standard Adapter. Used with most hole saws.	Reducer Adapter. Used with small hole saws.	



MACHINE ADJUSTMENTS

Two of the rollers have an eccentric tension adjuster, they are the ones that have a hexed shaped portion beneath the "V" roller.

1. To adjust, loosen the center bolt using a 1/2" wrench, and then with another wrench to hold the hex, rotate the hex slightly and the roller will either tighten or loosen as the hex eccentric is turned.
2. Give it a little tension and tighten the center screw, try the feed handwheel and check the resistance. The rollers should NOT be able to rotate by hand, that would be too loose.



LUBRICATION AND MAINTENANCE



WARNING: Make sure the electrical disconnect is OFF before working on the machine.

Maintenance should be performed on a regular basis by qualified personnel. Always follow proper safety precautions when working on or around any machinery.

- Check daily for any unsafe conditions and fix immediately.
- Check that all nuts and bolts are properly tightened.
- On a weekly basis clean the machine and the area around it.
- Lubricate threaded components and sliding devices.
- Apply rust inhibitive lubricant to all non-painted surfaces.



Note: Proper maintenance can increase the life expectancy of your machine.



PARTS DIAGRAM

Handwheel Assembly Parts Diagram

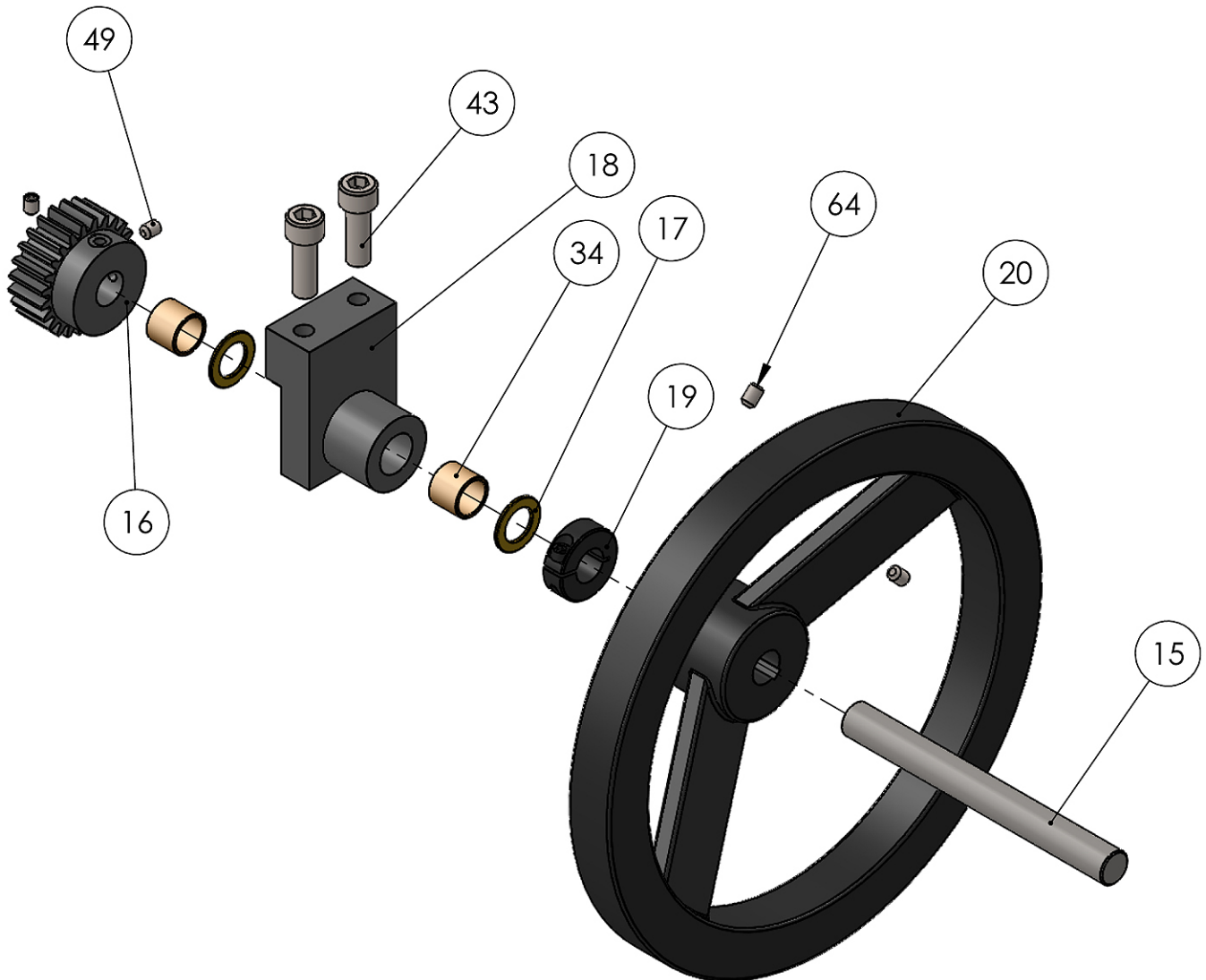



Main Tube Assembly Parts Diagram

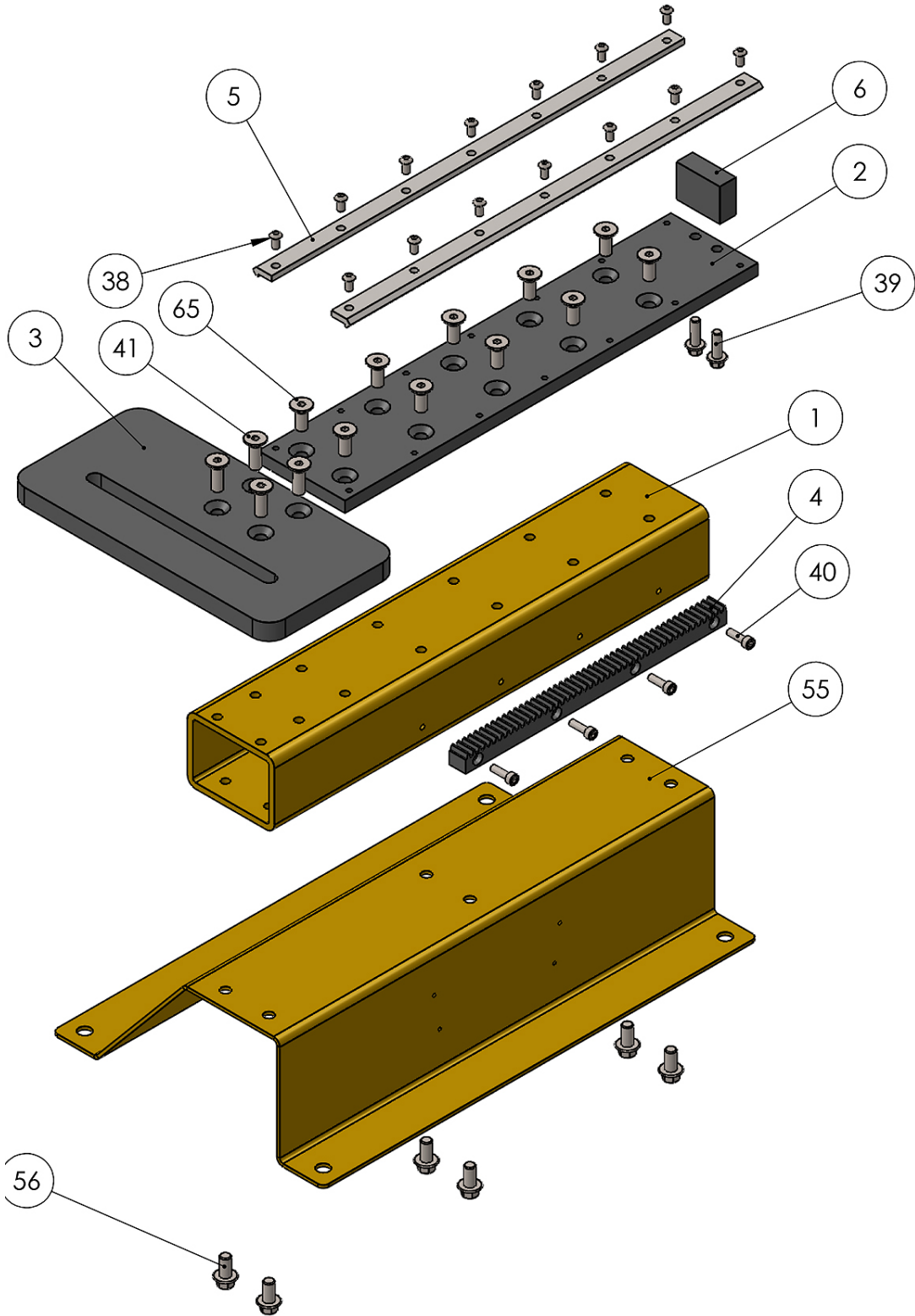



Roller Base Assembly Parts Diagram

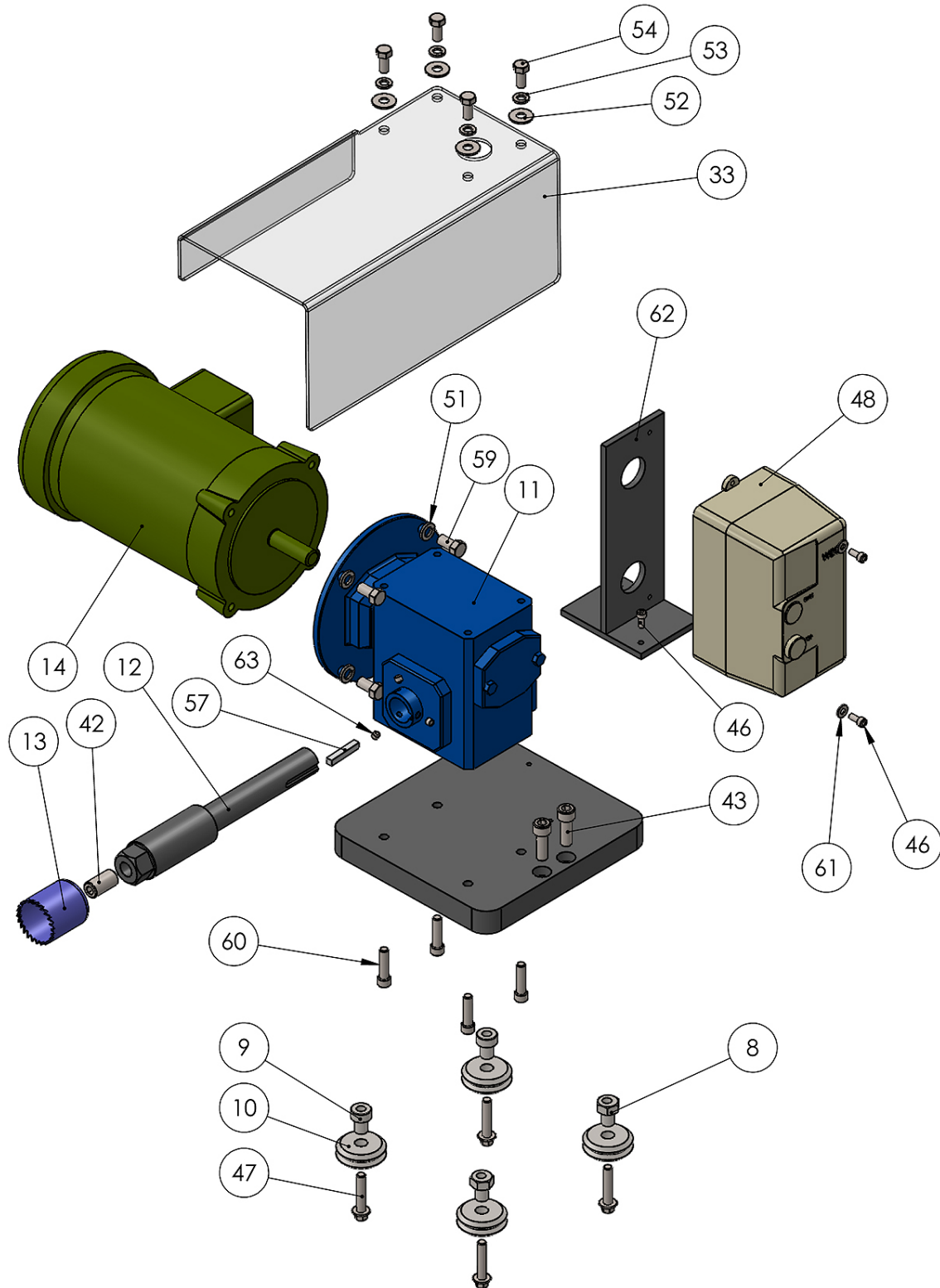



Lock Nut Assembly Parts Diagram

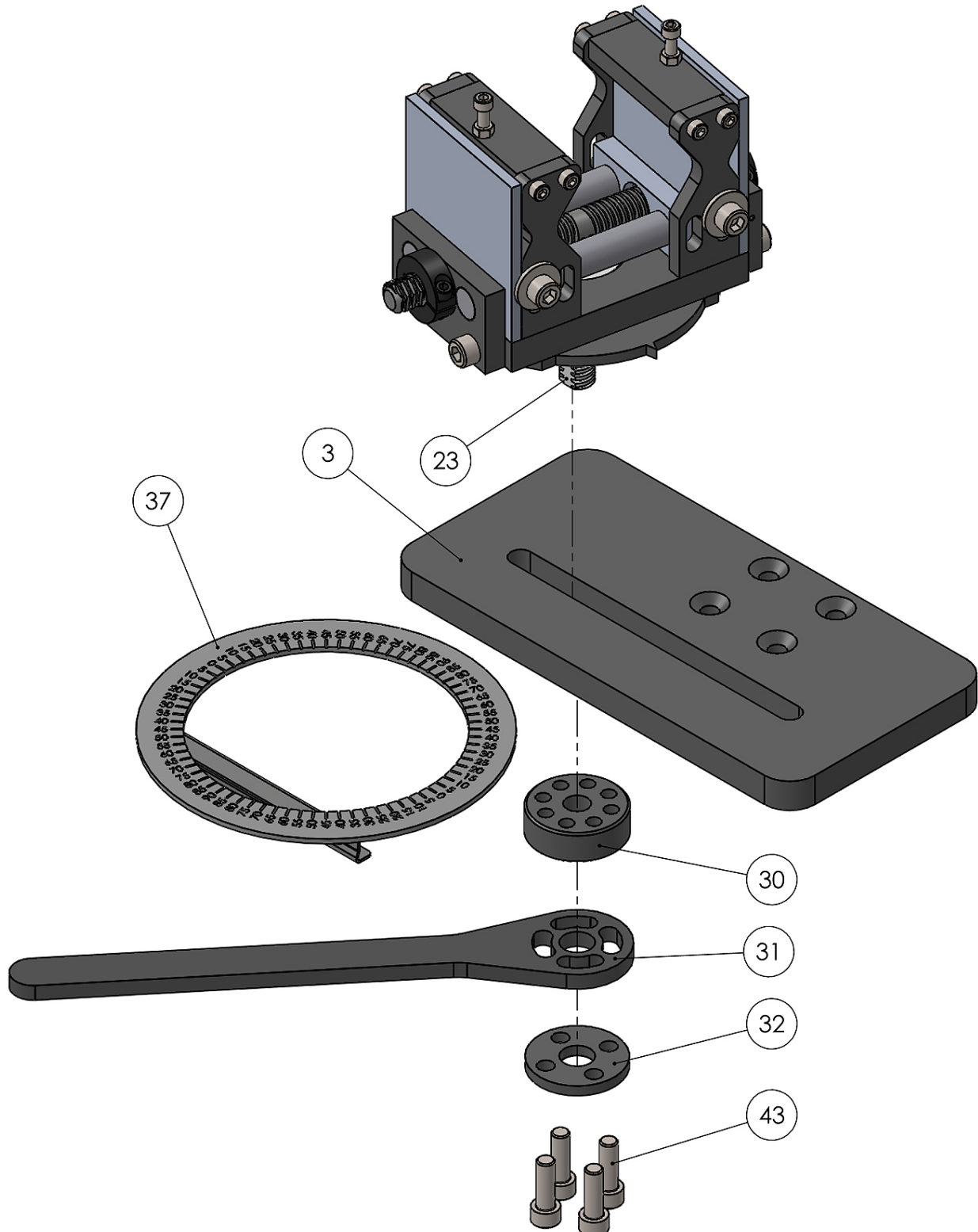



Vise Assembly Parts Diagram

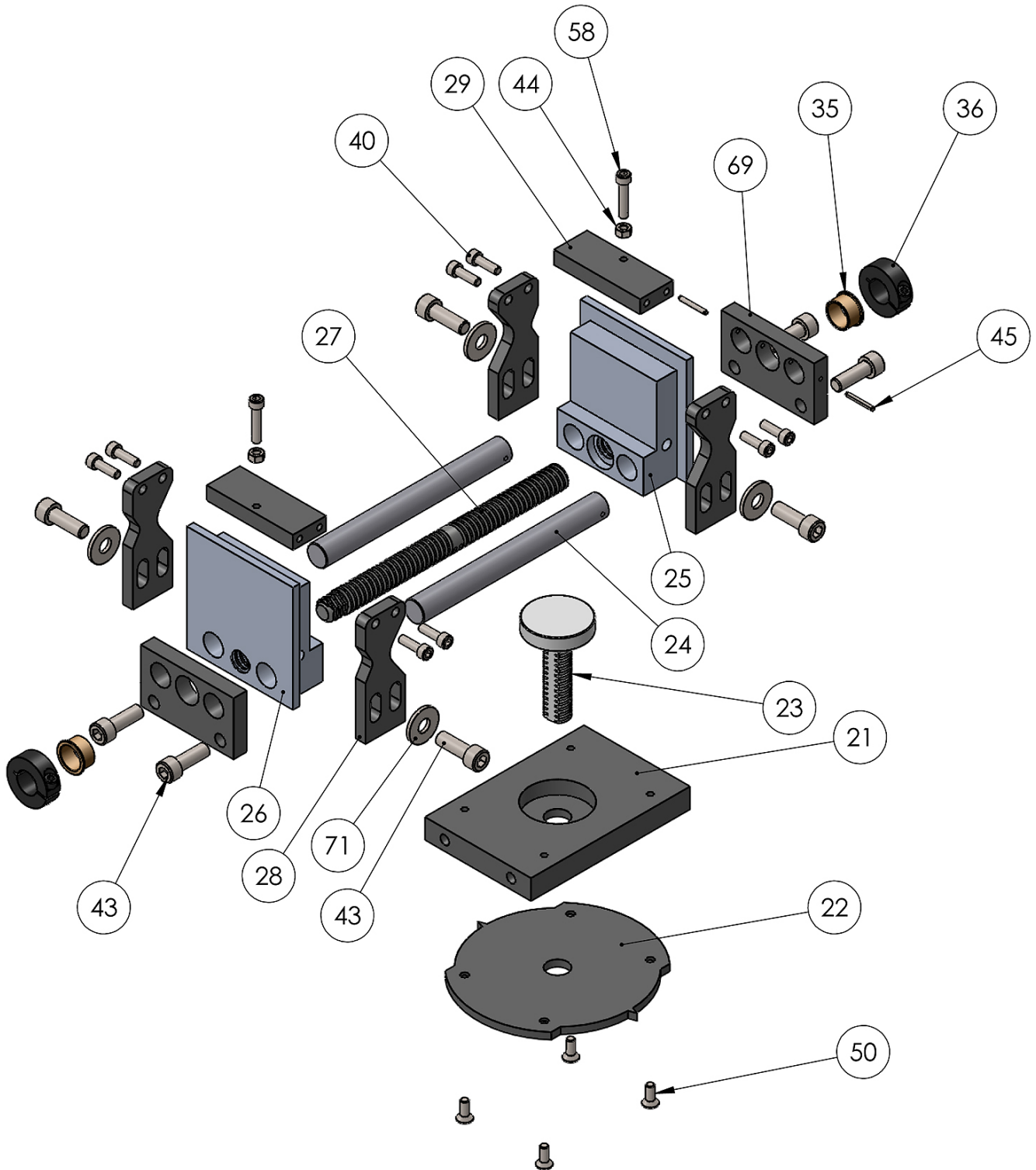



Electrical Box Assembly Parts Diagram

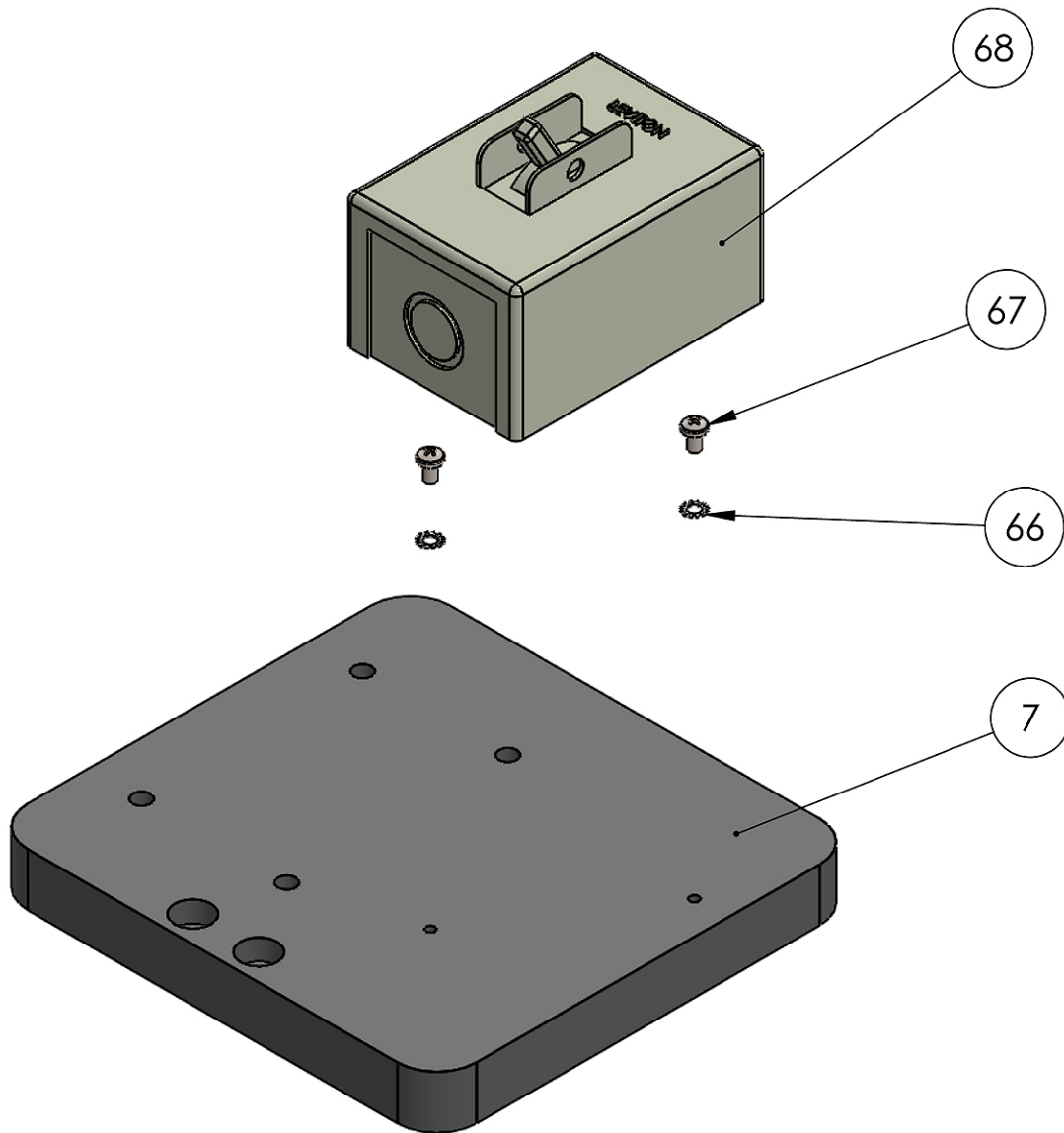



Parts List

Item	Part Number	Description	Qty.
1	ME-M600-6A001	Main Tube	1
2	ME-M600-6A003	Track Mount	1
3	ME-M600-6A005	Slide Plate	1
4	ME-M600-6A009	Gear Rack	1
5	M600-6A026	Vee Track 19"	2
6	ME-M600-6A017	Stop Block	1
7	ME-M600-6A004	Slide Plate	1
8	PP-0202-ME	Adjusting Bushing Wx3	2
9	PP-0203-ME	Non-Adjusting Bushing W3	2
10	PP-0201	V-Roller	4
11	PP-0962	Gearbox	1
12	ME-M600-7A001	Saw Arbor	1
13	PP-0971	1.75 Holesaw	1
14	PP-1074	1/2hp 1 Phase Motor	1
15	M600-7A003	Axle Shaft	1
16	ME-M600-7A004	24 Tooth Gear	1
17	PP-0168	.625 ID x 1.0 OD x .0625	2
18	ME-M600-6A006	Shaft Mount	1
19	PP-0958	5/8" Clamp Collar	1
20	PP-1031	10" Handwheel	1
21	ME-M900-6A047	Vise Base	1
22	ME-M900-6A052	Pointer Disc	1
23	M900-7A011	Vise Lock Stud	1
24	M900-7A014	Vise Slide Shaft	2
25	ME-M900-6A055	Vise Slide Block (L.H.)	1
26	ME-M900-6A049	Vise Slide Block (R.H.)	1
27	M900-7A012	Double Vise Screw	1
28	M900-6A050	Vise Jaw	4
29	ME-M900-6A051	Vise Cross Bar	2
30	ME-M900-6A042	Vise Lock Nut	1
31	M900-6A040	Lock Lever	1
32	M900-6A041	Lock Cap	1



Item	Part Number	Description	Qty.
33	M600-6A008	Lexan Guard	1
34	PP-0997	3/4 OD x 5/8 ID x 5/8 Lg Bush	2
35	PP-1063	.75 ID x .875 OD x .5 Flange Bushing	2
36	PP-0090	3/4" Split Collar	2
37	M600-5A002	Degree Dial	1
38	BSM-0138	M6 x 1.0 x 12 BHCS	14
39	BSM-0053	M8 x 1.25 x 25 Hex Flg	2
40	BSM-0002	M6 x 1.0 x 20 SHCS	12
41	BSM-0139	M10 x 1.5 x 30 FHCS	4
42	BS-0261	5/8-18 x 1.25 Set Screw	1
43	BSM-0016	M10 x 1.5 x 30 SHCS	2
44	BSM-0182	M6 x 1.0 Hex Nut	2
45	BS-0088	1/8 x 1 Slotted Spring Pin	2
46	BSM-0115	M5 x 0.8 x 12 SHCS	4
47	BSM-0054	M8 x 1.25 x 40 Hex Flg	4
48	PP-1295	CE On/Off Switch	1
49	BSM-0084	M6 x 1.0 x 8 Set Screw	2
50	BSM-0122	M6 x 1.0 x 16 FHCS	4
51	BS-0074	3/8 Lock Washer	4
52	BS-0082	5/16 Flat Washer	4
53	BS-0073	5/16 Lock Washer	4
54	BS-0039	5/16-18 x 3/4 HHCS	4
55	M600-6A007	Machine Stand	1
56	BSM-0058	M10 x 1.5 x 20 Hex Flg	6
57	M600-6A027	.25 x .25 x 1.50 Key	1
58	BSM-0004	M6 x 1.0 x 30 SHCS	2
59	BS-0114	.375-16 x .75 HHCS	4
60	BS-0171	5/16-18 x 1.25 SHCS	4
61	BS-0079	#10 Flat Washer	2
62	M600-5A003	Switch Weldment (CE)	1
63	BSM-0340	1/4-28 x .25 Set Screw	6
64	BS-0063	1/4-20 x .375 Set Screw	2
65	BSM-0133	M10 x 1.5 x 25 FHCS	10
66	BSM-0197	M5 Star Washer	2
67	BSM-0205	M5 x .8 x 8 PPMS	2



Item	Part Number	Description	Qty.
68	PP-0152	On/Off Switch (US)	1
69	M900-6A048	Vise Shaft Support	1
70	M900-6A075	Vise Shaft Support	1
71	BSM-0089	M10 Flat Washer	4





ELECTRICAL SCHEMATIC

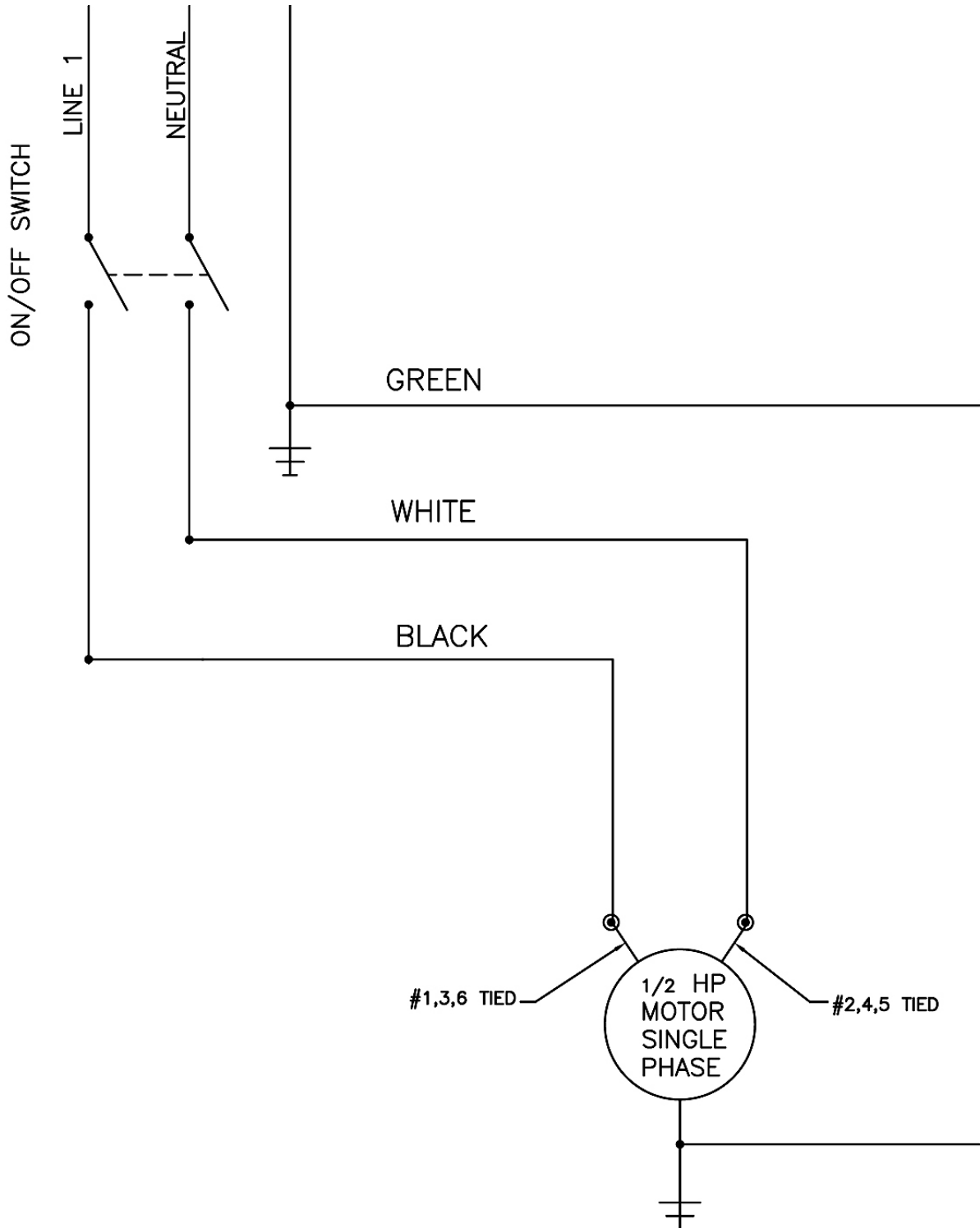

WARNING

General Machinery Safety Instructions

Machinery House
requires you to read this entire Manual before using this machine.

- 1. Read the entire Manual before starting machinery.** Machinery may cause serious injury if not correctly used.
- 2. Always use correct hearing protection when operating machinery.** Machinery noise may cause permanent hearing damage.
- 3. Machinery must never be used when tired, or under the influence of drugs or alcohol.** When running machinery you must be alert at all times.
- 4. Wear correct Clothing.** At all times remove all loose clothing, necklaces, rings, jewelry, etc. Long hair must be contained in a hair net. Non-slip protective footwear must be worn.
- 5. Always wear correct respirators around fumes or dust when operating machinery.** Machinery fumes & dust can cause serious respiratory illness. Dust extractors must be used where applicable.
- 6. Always wear correct safety glasses.** When machining you must use the correct eye protection to prevent injuring your eyes.
- 7. Keep work clean and make sure you have good lighting.** Cluttered and dark shadows may cause accidents.
- 8. Personnel must be properly trained or well supervised when operating machinery.** Make sure you have clear and safe understanding of the machine you are operating.
- 9. Keep children and visitors away.** Make sure children and visitors are at a safe distance for you work area.
- 10. Keep your workshop childproof.** Use padlocks, Turn off master power switches and remove start switch keys.
- 11. Never leave machine unattended.** Turn power off and wait till machine has come to a complete stop before leaving the machine unattended.
- 12. Make a safe working environment.** Do not use machine in a damp, wet area, or where flammable or noxious fumes may exist.
- 13. Disconnect main power before service machine.** Make sure power switch is in the off position before re-connecting.
- 14. Use correct amperage extension cords.** Undersized extension cords overheat and lose power. Replace extension cords if they become damaged.
- 15. Keep machine well maintained.** Keep blades sharp and clean for best and safest performance. Follow instructions when lubricating and changing accessories.
- 16. Keep machine well guarded.** Make sure guards on machine are in place and are all working correctly.
- 17. Do not overreach.** Keep proper footing and balance at all times.
- 18. Secure workpiece.** Use clamps or a vice to hold the workpiece where practical. Keeping the workpiece secure will free up your hand to operate the machine and will protect hand from injury.
- 19. Check machine over before operating.** Check machine for damaged parts, loose bolts, Keys and wrenches left on machine and any other conditions that may effect the machines operation. Repair and replace damaged parts.
- 20. Use recommended accessories.** Refer to instruction manual or ask correct service officer when using accessories. The use of improper accessories may cause the risk of injury.
- 21. Do not force machinery.** Work at the speed and capacity at which the machine or accessory was designed.
- 22. Use correct lifting practice.** Always use the correct lifting methods when using machinery. Incorrect lifting methods can cause serious injury.
- 23. Lock mobile bases.** Make sure any mobile bases are locked before using machine.
- 24. Allergic reactions.** Certain metal shavings and cutting fluids may cause an allergic reaction in people and animals, especially when cutting as the fumes can be inhaled. Make sure you know what type of metal and cutting fluid you will be exposed to and how to avoid contamination.
- 25. Call for help.** If at any time you experience difficulties, stop the machine and call you nearest branch service department for help.

WARNING

Pipe/Tube Notcher-Electric Safety Instructions

Machinery House
requires you to read this entire Manual before using this machine.

- 1. Maintenance.** Make sure the Pipe/Tube Notcher is turned off and disconnect from the main power supply and make sure all moving parts have come to a complete stop before any inspection, adjustment or maintenance is carried out.
- 2. Pipe/Tube Notcher Condition.** Pipe/Tube Notcher must be maintained for a proper working condition. Never operate a Pipe/Tube Notcher that has damaged or worn parts. Scheduled routine maintenance should performed on a scheduled basis.
- 3. Leaving a Pipe/Tube Notcher Unattended.** Always turn the Pipe/Tube Notcher off and make sure all moving parts have come to a complete stop before leaving the Pipe/Tube Notcher. Do not leave Pipe/Tube Notcher running unattended for any reason.
- 4. Avoiding Entanglement.** Remove loose clothing, belts, or jewelry items. Never wear gloves while machine is in operation. Tie up long hair and use the correct hair nets to avoid any entanglement with the Pipe/Tube Notcher spindle or moving parts.
- 5. Adjusting spanner safety.** Always check and remove all adjusting spanners and service tools immediately before & after use as this can cause serious injury.
- 6. Understand the machines controls.** Make sure you understand the use and operation of all controls.
- 7. Tooling selection & holding.** Always use the correct cutting tool for the job you are Notching. Make sure it is sharp and held firmly in place.
- 8. Cutting Tool inspection.** Inspect cutting tool bit for sharpness, chips, or cracks before use. Replace any cutting tools immediately if dull, chipped or cracked. Handle new cutting tools with care. Cutting edges are very sharp and can cause lacerations.
- 9. Stopping the spindle.** Do not slow or stop the spindle by using you hand.
- 10. Speed selection.** Select the appropriate speed for the type of work, material, and tool bit. Allow the Pipe/Tube Notcher to reach full speed before beginning to notch.
- 11. Secure Material.** During the notching process, the workpiece must always be secured in the work holding vice.
- 12. Guards.** Do not operate Pipe/Tube Notcher without the correct guards in place.
- 13. Clearing chips.** Always use a brush to clear chips. Never clear chips when the Pipe/Tube Notcher is running.
- 14. Hand Hazard.** Keep hands and fingers clear from moving parts. Serious injury will occur if hand or finger tips come between workpiece and notching area.
- 15. Work area hazards.** Keep the area around the Pipe/Tube Notcher clean from oil, tools, objects & swarf. Pay attention to other persons in the area and know what is going on around the area to ensure unintended accidents.
- 16. Switching.** Always turn the Pipe/Tube Notcher off and make sure all moving parts have come to a complete stop before leaving. Do not leave running unattended for any reason.
- 17. Power outage.** In the event of a power failure during use of the Pipe/Tube Notcher, turn off all switches to avoid possible sudden start up once power is restored.
- 18. Glasses.** Always wear approved safety glasses when using this machine.
- 19. Authorized and trained personnel.** The machine must be operated by authorized and trained personnel.
- 20. Keep Children Away.** Children must never be allowed in the work area.
- 21. Call for help.** If at any time you experience difficulties, stop the machine and call you nearest branch service department for help.

PLANT SAFETY PROGRAM

NEW MACHINERY HAZARD IDENTIFICATION, ASSESSMENT & CONTROL

Pipe/Tube Notcher - Electric

Developed in Co-operation Between A.W.I.S.A and Australia Chamber of Manufactures
This program is based upon the Safe Work Australia, Code of Practice - Managing Risks of Plant in the Workplace (WHSA 2011 No10)

Item No.	Hazard Identification	Hazard Assessment	Risk Control Strategies <small>(Recommended for: Purchase / Buyer / User)</small>
A	ENTANGLEMENT	HIGH	Eliminate, avoid loose clothing / Long hair etc.
B	CRUSHING	LOW	Secure & support work material on Notcher. Use machine on solid level working surface.
C	CUTTING, STABBING, PUNCTURING	MEDIUM	Make sure all guard are secured shut when machine is on. Do not adjust or clean machine until the machine has fully stopped. Isolate power to machine prior to any checks or maintenance being carried out. Do not place hands or fingers inside moving parts of notcher.
D	SHEARING	MEDIUM	Make sure all guard are secured shut when machine is on. Do not place hands or fingers inside moving parts of notcher.
F	STRIKING	LOW	Ensure work material and cutter are securely fastened before use. Wear safety glasses. Stand clear of moving parts on machine.
H	ELECTRICAL	MEDIUM	Remove all loose objects around moving parts. Ensure work hold table is correctly adjusted before use.
M	HIGH TEMPERATURE	LOW	All electrical enclosures should only be opened with a tool that is not to be kept with the machine.
O	OTHER HAZARDS, NOISE	LOW	Wear appropriate clothing to prevent hot swarf. Wear hearing protection as required.
Plant Safety Program to be read in conjunction with manufactures instructions			



www.machineryhouse.com.au



www.machineryhouse.co.nz

Authorised and signed by: _____
 Safety officer: _____
 Manager: 

Revised Date: 25th January 2019