

## Powermax105®

Duramax® 75° hand torch consumables



### Drag Cutting (30-85A)

For longer consumable life when cutting metal 12 mm and under, check out the CopperPlus electrode (part number P8371)

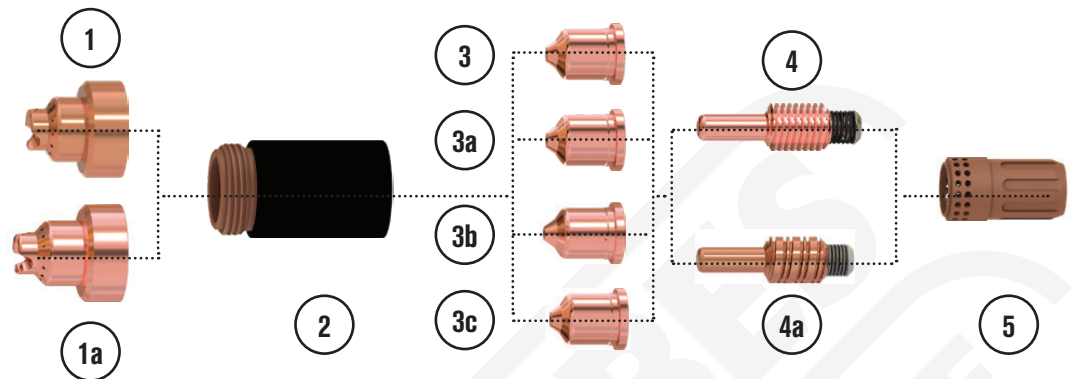

Item	Order Number	Part Number	Description
1	P8452	220818	Shield / Deflector 85A - Packet of 1
1a	P8450	220992	Shield / Deflector 105A - Packet of 1
2	P848	220854	Retaining Cap - Packet of 1
3	P838	220941	Nozzle 45A - Packet of 5
3a	P839	220819	Nozzle 65A - Packet of 5
3b	P840	220816	Nozzle 65A - Packet of 5
3c	P841	220990	Nozzle 105A - Packet of 5
4	P837	220842	Electrode - Packet of 5
4a	P8371	220777	Copperplus Electrode - Packet of 5
5	P844	220994	Swirl ring Packet of 1

### FineCut (30-45A)



Item	Order Number	Part Number	Description
1	P8472	220931	Shield / Deflector - Packet of 1
2	P848	220854	Retaining Cap - Packet of 1
3	P842	220930	Nozzle - Packet of 5
4	P837	220842	Electrode - Packet of 5
5	P8431	220947	Swirl Ring - Packet of 1

# Powermax105<sup>®</sup> Duramax<sup>®</sup> 75° hand torch consumables - continued

## Max Removal Gouging (45-105A)

The Max removal gouging shield is designed for aggressive metal removal, deep gouge profiles and extreme metal washing.

## Max Control Gouging (45-105A)

The Max control gouging shield is designed for more precise metal removal, shallower gouge profiles and light metal washing.

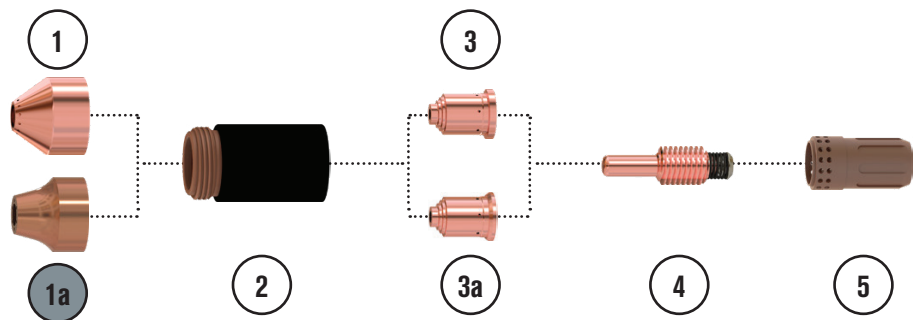

Item	Order Number	Part Number	Description
1	P8455	220798	Shield / Deflector - Packet of 1
1a	P8453	420480	Shield / Deflector - Packet of 1
2	P848	220854	Retaining Cap - Packet of 1
3	P8390	220797	Nozzle 85A - Packet of 5
3a	P8391	220991	Nozzle 105A - Packet of 5
4	P837	220842	Electrode - Packet of 5
5	P844	220994	Swirl ring Packet of 1

## HyAccess Drag-Cutting (30-65A)

**Warning:** The Duramax HyAccess (65 amps and below) consumables should not be operated above 65 amps

## HyAccess Gouging (30-65A)

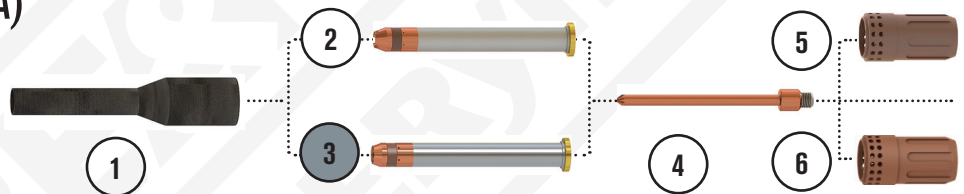

Item	Order Number	Part Number	Description
1	P8482	420413	Retaining Cap- Packet of 1
2	P8383	420410	Cutting Nozzle - Packet of 1
3	P8384	420412	Gouging Nozzle - Packet of 1
4	P8372	420408	Electrode - Packet of 1
5	P843	220857	Swirl ring 85A Packet of 1
6	P844	220994	Swirl ring 105A Packet of 1

## FlushCut (30-45A)

**Warning:** Using the 45 amp FlushCut consumables on the Powermax105 above 45 amps will cause premature consumable damage.

## FlushCut (65-105A)

For longer consumable life when cutting metal 12 mm and under, check out the CopperPlus electrode (part number P8371)

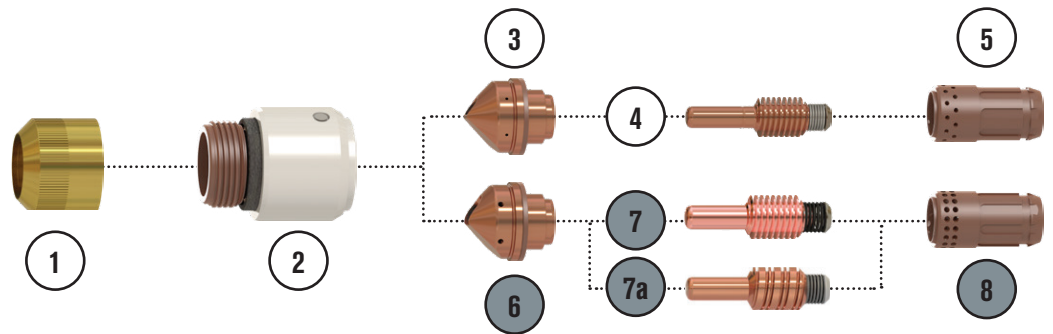

Item	Order Number	Part Number	Description
1	P8484	420540	Retaining Ring - Packet of 1
2	P8483	420536	Retaining Cap - Packet of 1
3	P8385	420633	Nozzle/Shield assembly - Packet of 1
4	P8373	420635	Electrode - Packet of 5
5	P8432	420634	Swirl Ring 45A - Packet of 1
6	P8386	420533	Nozzle/Shield assembly 105A- Packet of 1
7	P837	220842	Electrode - Packet of 5
7a	P8371	220777	CopperPlus Electrode - Packet of 5
8	P8433	420539	Swirl Ring 105A - Packet of 1