

### HYDRAULIC TABLE CART DIAGRAM

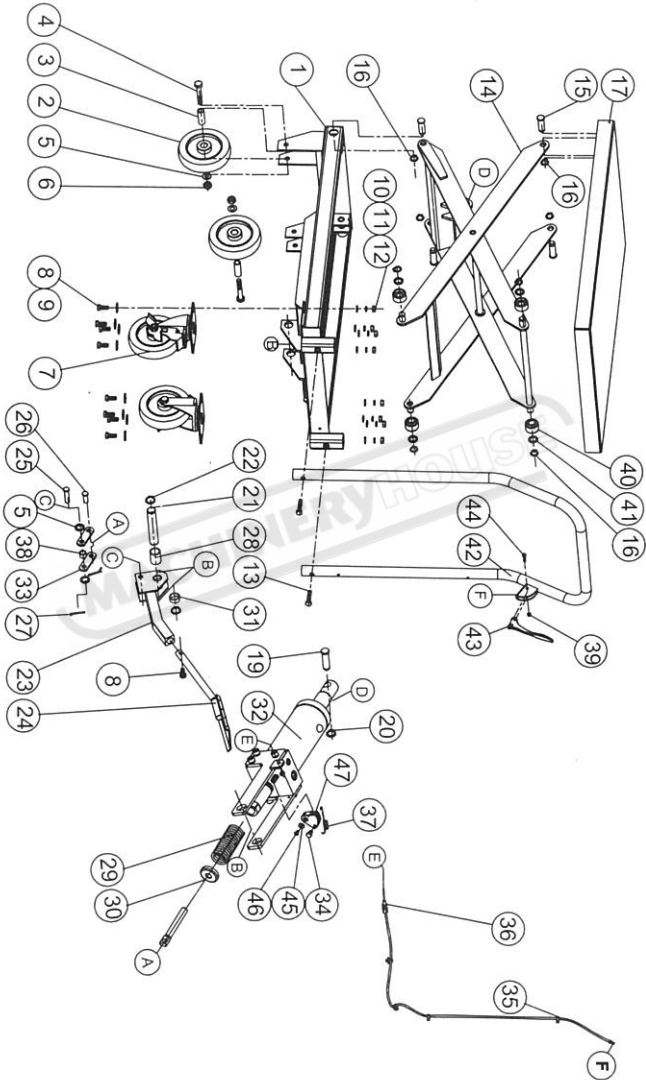

**PARTS LIST**

Ref#	Drawing No.	Description	Qty
1	T012-3000	Base Assembly	1
2	T012-00014	Wheel	2
3	T012-00013	Bushing	2
4	9101-10065-DX	Hex Bolt M10x65	2
5	9301-10000-DX	Flat Washer $\varnothing 10$	4
6	9206-10000-DX	Nylon Lock Nut M10	2
7	T012-00012	Swivel Wheel	2
8	9102-08020	Hex Bolt M8x20	9
9	9302-08000-DX	Big Flat Washer $\varnothing 8$	8
10	9301-08000-DX	Flat Washer $\varnothing 8$	8
11	9306-08000-DX	Lock Washer $\varnothing 8$	8
12	9201-08000-DX	Hex Nut M8	8
13	9102-08040-DX	Hex Bolt M8x40	2
14	T012-20000	Lift Frame	1
15	T012-00001-DX	Hinge Pin	4
16	9304-14000-FH	Snap Ring $\varnothing 14$	8
17	T012-10000	Tabletop	1
19	T012-00004-DX	Hinge Pin of Pump	1
20	9304-16000-FH	Snap Ring $\varnothing 16$	1
21	T012-00007-DX	Long Axis	1
22	9304-20000-FH	Snap Ring $\varnothing 20$	2
23	T013-60000	Lifting Pedal Base	1
24	T012-70000	Lifting Pedal	1
25	T012-00015-DX	Handle Pin	1
26	T012-00011-DX	Connecting Rod Pin	1
27	9404-03025-DX	Cotter Pin $\varnothing 3 \times 25$	2
28	T012-00008-DX	Long Bushing	1
29	T012-00005-FH	Pressure Spring	1
30	T012-00006-DX	Pressure Spring Cover	1
31	T012-00009-DX	Short Bushing	1
32	T012-50000	Jack	1
33	T012-00002-DX	Connecting Rod	2

**PARTS LIST**

Ref#	Drawing No.	Description	Qty
34	9101-05010-DX	Hex Bolt M5x10	1
35	RH-6	Wire Fix Bracket	4
36	T012-40000	Release Wire	1
37	T012-40002-FH	Tension Spring	1
38	T012-00010-DX	Small Washer	1
39	9206-05000-DX	Nylon Lock Nut M5	1
40	T012-20002	Small Wheel	4
41	T012-20003-DX	Small Flat Washer	4
42	T012-80000-DG	Push Handle	1
43	T012-40004-DG	Release Handle	1
44	9101-05020-DX	Hex Bolt M5x20	1
45	9302-05000-DX	Big Flat Washer Ø5	1
46	9110-05008-DX	Screw M5x8	1
47	T012-40003	Strut Adjusting Box	1

MACHINERYHOUSE