

# Hypertherm®

Cut with confidence®

## Powermax85®

Duramax® 75° hand torch consumables

**HARE & FORBES**  
**MACHINERYHOUSE**



### Drag Cutting (30-85A)

For longer consumable life when cutting metal 12 mm and under, check out the CopperPlus electrode (part number P8371)

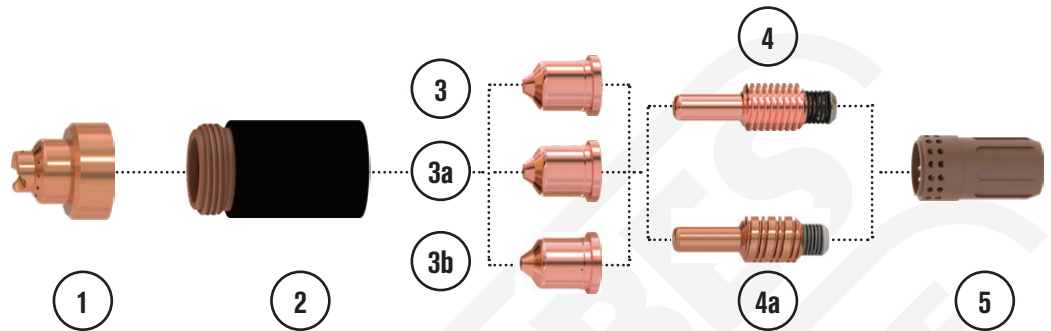

Item	Order Number	Part Number	Description
1	P8452	220818	Shield / Deflector - Packet of 1
2	P848	220854	Retaining Cap - Packet of 1
3	P838	220941	Nozzle 45A - Packet of 5
3a	P839	220819	Nozzle 65A - Packet of 5
3b	P840	220816	Nozzle 65A - Packet of 5
4	P837	220842	Electrode - Packet of 5
4a	P8371	220777	Copperplus Electrode - Packet of 5
5	P843	220857	Swirl ring Packet of 1

### FineCut (30-45A)

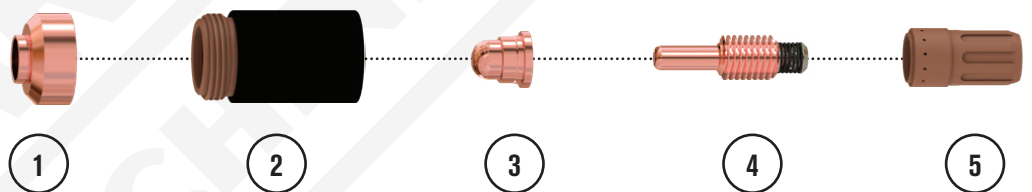

Item	Order Number	Part Number	Description
1	P8472	220931	Shield / Deflector - Packet of 1
2	P848	220854	Retaining Cap - Packet of 1
3	P842	220930	Nozzle - Packet of 5
4	P837	220842	Electrode - Packet of 5
5	P8431	220947	Swirl Ring - Packet of 1

Order online @ [www.machineryhouse.com.au](http://www.machineryhouse.com.au)

### Max Removal Gouging (45-85A)

The Max removal gouging shield is designed for aggressive metal removal, deep gouge profiles and extreme metal washing.

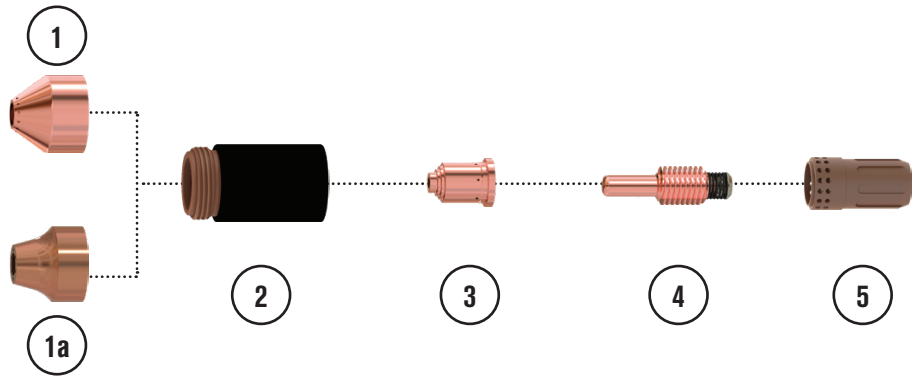

### Max Control Gouging (45-85A)

The Max control gouging shield is designed for more precise metal removal, shallower gouge profiles and light metal washing.

Item	Order Number	Part Number	Description
1	P8455	220798	Shield / Deflector - Packet of 1
1a	P8453	420480	Shield / Deflector - Packet of 1
2	P848	220854	Retaining Cap - Packet of 1
3	P8390	220797	Nozzle - Packet of 5
4	P837	220842	Electrode - Packet of 5
5	P843	220857	Swirl ring Packet of 1

### HyAccess Drag-Cutting (30-65A)

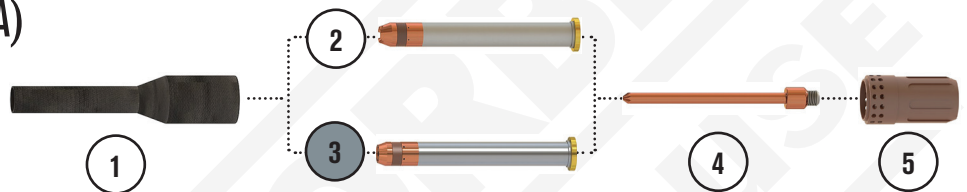

### HyAccess Gouging (30-65A)

Item	Order Number	Part Number	Description
1	P8482	420413	Retaining Cap- Packet of 1
2	P8383	420410	Cutting Nozzle - Packet of 1
3	P8384	420412	Gouging Nozzle - Packet of 1
4	P8372	420408	Electrode - Packet of 1
5	P843	220857	Swirl ring Packet of 1

### FlushCut (30-45A)

**Warning:** Using the 45 amp FlushCut consumables on the Powermax85 above 45 amps will cause premature consumable damage



Item	Order Number	Part Number	Description
1	P8484	420540	Retaining Ring - Packet of 1
2	P8483	420536	Retaining Cap - Packet of 1
3	P8385	420633	Nozzle/Shield assembly - Packet of 1
4	P8373	420635	Electrode - Packet of 5
5	P8432	420634	Swirl Ring - Packet of 1