

Powermax45® XP

Duramax® 75° hand torch consumables



Drag Cutting (15-45A)

For longer consumable life when cutting metal 12 mm and under, check out the CopperPlus electrode (part number P8371)

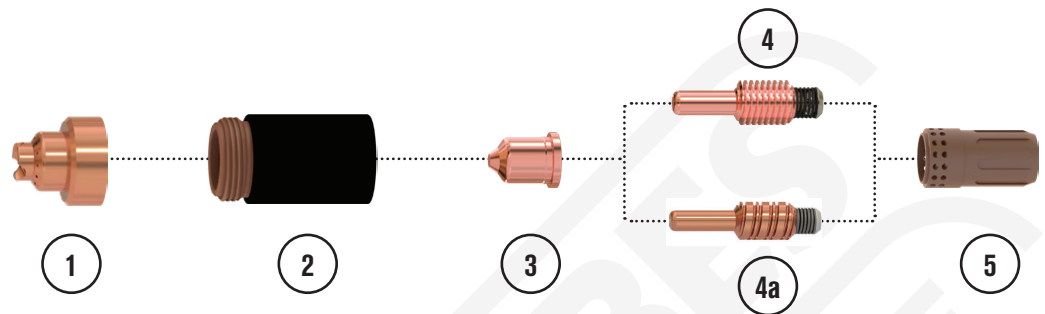

Item	Order Number	Part Number	Description
1	P8452	220818	Shield / Deflector - Packet of 1
2	P848	220854	Retaining Cap - Packet of 1
3	P838	220941	Nozzle - Packet of 5
4	P837	220842	Electrode - Packet of 5
4a	P8371	220777	Electrode Copper Plus - Packet of 5
5	P843	220857	Swirl ring Packet of 1

FineCut (30-45A)

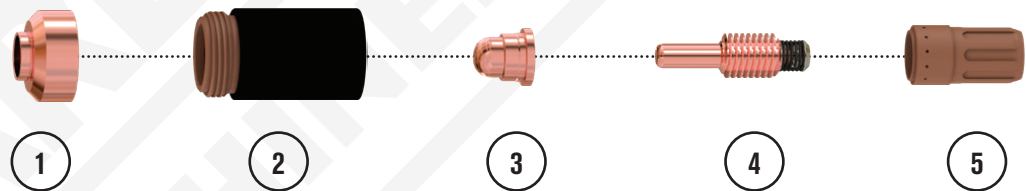

Item	Order Number	Part Number	Description
1	P8472	220931	Shield / Deflector - Packet of 1
2	P848	220854	Retaining Cap - Packet of 1
3	P842	220930	Nozzle - Packet of 5
4	P837	220842	Electrode - Packet of 5
5	P8431	220947	Swirl Ring - Packet of 1

Powermax45[®] XP Duramax[®] 75° hand torch consumables - continued.

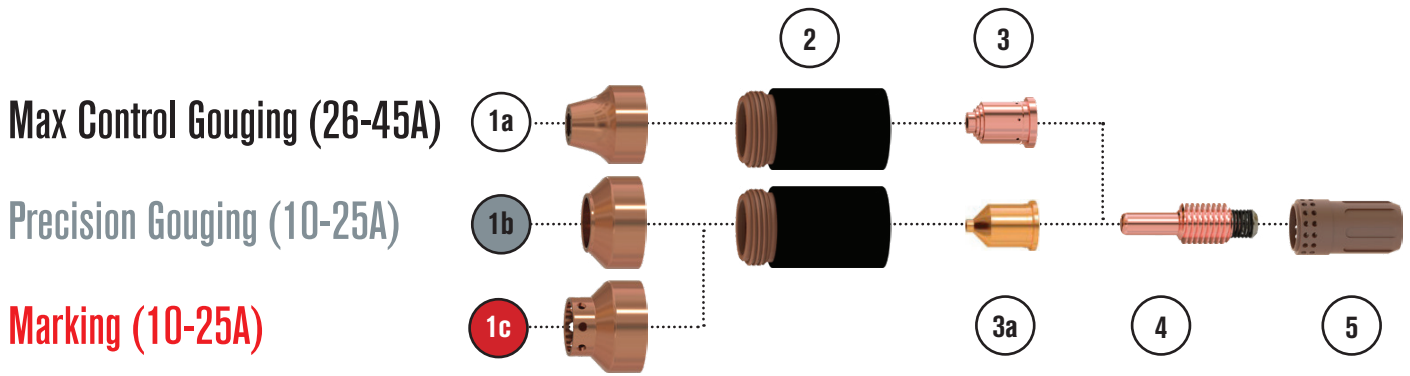

Item	Order Number	Part Number	Description
1a	P8453	420480	Shield / Deflector Control Gouging - Packet of 1
1b	P8454	420414	Shield / Deflector Precision Gouging- Packet of 1
1c	P8451	420542	Shield / Deflector Marking - Packet of 1
2	P848	220854	Retaining Cap - Packet of 1
3	P8382	420419	Nozzle - Packet of 5
3a	P8381	420415	Nozzle - Packet of 5
4	P837	220842	Electrode - Packet 5
5	P843	220857	Swirl ring Packet of 1

HyAccess Drag-Cutting (15-45A)

HyAccess Gouging (15-45A)

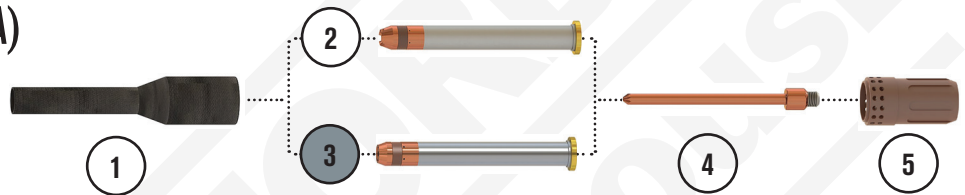

Item	Order Number	Part Number	Description
1	P8482	420413	Retaining Cap- Packet of 1
2	P8383	420410	Cutting Nozzle - Packet of 1
3	P8384	420412	Gouging Nozzle - Packet of 1
4	P8372	420408	Electrode - Packet of 1
5	P843	220857	Swirl ring Packet of 1

FlushCut (30-45A)

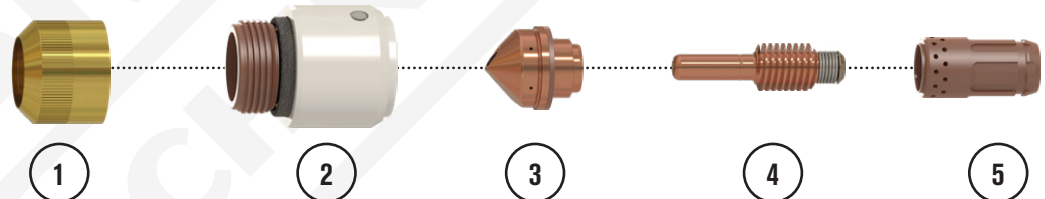

Item	Order Number	Part Number	Description
1	P8484	420540	Retaining Ring - Packet of 1
2	P8483	420536	Retaining Cap - Packet of 1
3	P8385	420633	Nozzle/Shield assembly - Packet of 1
4	P8373	420635	Electrode - Packet of 5
5	P8432	420634	Swirl Ring - Packet of 5