

# Hypertherm®

## MAXPRO200®



### MAXPRO200 machine torch consumables

#### Air – Mild steel/Stainless steel/Aluminum

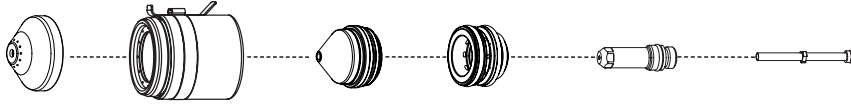

	Shield	Shield cap	Nozzle	Swirl ring	Electrode	Water tube
<b>50 A</b>	220532	220936	220890	220529	220528	220521
<b>130 A</b>	220536	220936	220892	220488	220487	220521
<b>200 A</b>	420045	220936	420044	220488	220937	220521

#### O<sub>2</sub> – Mild steel

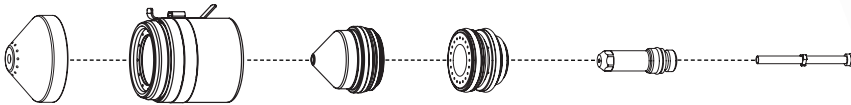

	Shield	Shield cap	Nozzle	Swirl ring	Electrode	Water tube
<b>50 A</b>	220532	220936	220891	220529	220528	220521
<b>130 A</b>	220491	220936	220893	220488	220487	220521
<b>200 A</b>	220832	220936	220831	220834	220937	220521

#### N<sub>2</sub> – Stainless steel/Aluminum

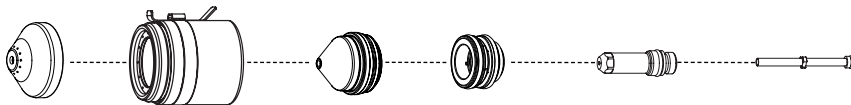

	Shield	Shield cap	Nozzle	Swirl ring	Electrode	Water tube
<b>130 A</b>	220536	220936	220892	220529	020415	220521
<b>200 A</b>	420045	220936	420044	220529	020415	220521



MAXPRO200 quick-disconnect machine torch



MAXPRO200 straight machine torch