

SB15 MIG TORCH

180A AIR COOLED MIG WELDING TORCH

Rating: 180A CO² 150A mixed gas EN60974-7 @ 60% duty cycle. 0.6 to 1.0mm wires

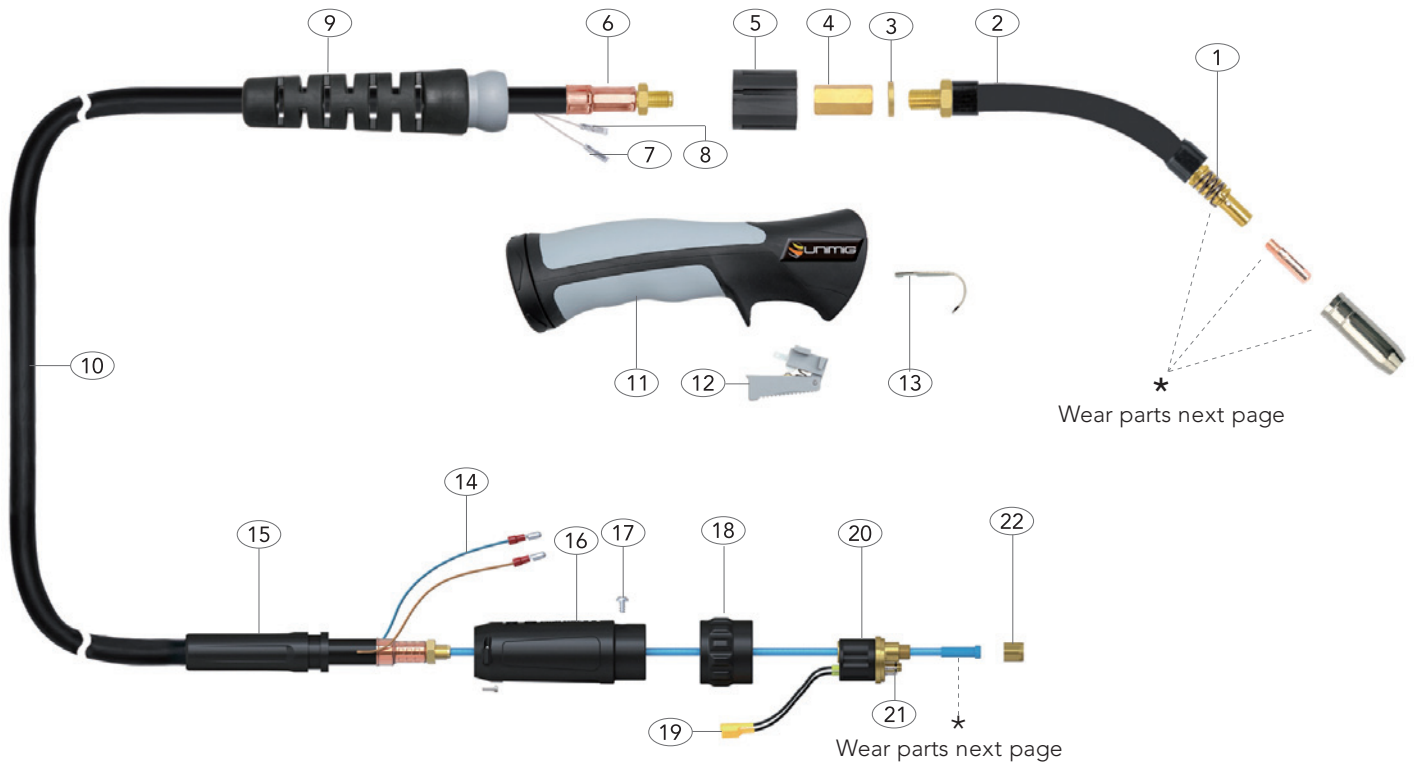

Torch Model			
Description	Part Number		
	3 Mt	4 Mt	5 Mt
SB Suregrip Ergo Torch Package	SB15-3M	SB15-4M	SB15-5M

Spare Parts					
Part Number	Description	Part Number	Description	Part Number	Description
1	GNS15	11	UG2514	11	Ergo Handle Kit C/W Lock Nut
2	SNK15	12	UG2516	12	Medium / Large Ergo Trigger
	SNKF15	13	UB2517	13	Hanger Hook
3	UB2501/5	14	UB1522	14	Cable Terminal Male
4	UB2519	15	UPA2041	15	Cable Support
5	UG1515	16	UB1518	16	Gun Plug Housing C/W Nut
6	UB1505	17	UB1541	17	Gun Plug Screw
7	UB1521	18	UB1519PL	18	Gun Plug Nut
8	UB1521-C	19	UB1523	19	Gun Plug Terminal Female
9	UG8015	20	UC1528	20	Hybrid Gun Plug Body C/W Spring Pins
10	UB1517-30	21	UB1524	21	Gun Plug 'O' Ring
	UB1517-40	22	UB1525	22	Liner Nut
	UB1517-50				

SB15 MIG TORCH

Front end consumables

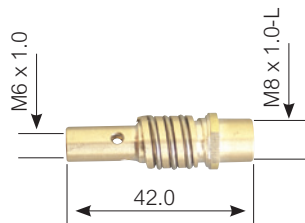
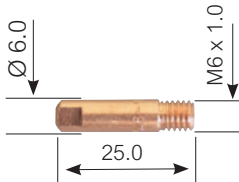

Liners



SB15 Contact Tips

Part Number	Description	QTY
PCT0008-06	Contact Tip Steel (0.6mm)	QTY10
PCT0008-08	Contact Tip Steel (0.8mm)	QTY10
PCT0008-09	Contact Tip Steel (0.9mm)	QTY10
PCT0008-10	Contact Tip Steel (1.0mm)	QTY10
PCTAL0008-09	Contact Tip Aluminium (0.9mm)	QTY10
PCTAL0008-10	Contact Tip Aluminium (1.0mm)	QTY10

SB15 Tip Holder

Part Number	Description	QTY
PCTH15	Contact Tip Holder (Suit SB15)	QTY2
PGNS15	Shroud Spring	QTY2

SB15 Gas Nozzle

Part Number	Description	QTY
PGN15CYL	Cylindrical Nozzle	QTY2
PGN15CON	Conical Nozzle	QTY2
PGN15TAP	Tapered Nozzle	QTY2
PGN15SPOT	Spot Nozzle	QTY2

SB15 Liners

Part Number	Description	QTY
SLB3M	Blue Steel Liner 3 Metre	} 0.6 - 0.9mm
SLB4M	Blue Steel Liner 4 Metre	
SLB5M	Blue Steel Liner 5 Metre	
SLR3M	Red Steel Liner 3 Metre	} 1.0 - 1.2mm
SLR4M	Red Steel Liner 4 Metre	
SLR5M	Red Steel Liner 5 Metre	
TLB3M	Blue Aluminium Liner 3 Metre	} 0.6 - 0.9mm
TLB4M	Blue Aluminium Liner 4 Metre	
TLR3M	Red Aluminium Liner 3 Metre	} 1.0 - 1.2mm
TLR4M	Red Aluminium Liner 4 Metre	
NKSTL	Neck Spring for Aluminium	

These parts are manufactured in China and are offered as replacement parts suitable for "BINZEL®" style torches.